

SOLO Station 1500-3

PV Station 1500 kW
with High Voltage Transformer

IDS Trade AG
Samstagernstrasse 55
CH – 8832 Wollerau / Switzerland

Phone +41 44 562 06 00
Fax +41 44 562 06 06
sales@ids.ch
www.ids.ch

Datasheet

Type	SOLO Station 1500-3 / ISS-15-20
------	---------------------------------

Grid Data

Nominal AC power (P_{AC})	1500 kW	
Nominal AC current (I_{AC})	43.3 A	
Grid voltage (U_{AC})	20 kV	+10 % / -15 %; others see under options
Grid frequency (f_{AC})	50 Hz / 60 Hz	± 10 %
Surge arrester	Yes	
Harmonic distortion (%THD I_{AC})	< 3 %	
Power factor ($\cos \phi$)	-0.95 ... +0.95	0.95 capacitive ... 0.95 inductive
Efficiency	98.2 %	Without transformer
Euro eta	97.8 %	Without transformer
Auxiliary power supply	3 x 400 V _{AC} , 50 / 60 Hz	TN-S; surge protection type 2

Photovoltaic Data

Nominal PV power (P_{PV})	1524 kW	
Control strategy	MPPT	Maximum Power Point Tracking
Number of MPP trackers	3	9 separately switchable PV sections
Max. DC current on each PV input	9 x 380 A	
DC voltage range for MPPT	500 V _{DC} ... 1100 V _{DC}	
Maximum permissible PV voltage (U_{PVmax})	1200 V _{DC}	
Voltage ripple U_{pp} (PV input)	< 3 %	
Surge protection (PV input)	Type 2	Monitored
Grounding (PV input)	Floating	Option: Connection to PV(-) or PV(+) input

Communication and Control Interface

Communication interface	EIA-485, Ethernet	Others see under options
Data logger interface	IDS web portal	Others see under options

Options

Other AC operating voltages according to local requirements available on request
Power limitation control / Grid monitoring: BDEW regulations / Further on request
Connecting PV(-) or PV(+) input to ground (inclusive earth current monitoring)
Communication: GSM- or line modem, Modbus, CAN, Interbus, PROFIBUS
Data logger: SolarLog, Meteocontrol, others on request
Energy counter

SOLO Station 1500-3 Datasheet

Container and Ambient Conditions

Dimensions (W x D x H)	7620 x 2230 x 2590 mm	Without foundation
Foundation height (H)	600 mm	Depending on surrounding conditions
Weight (m)	12000 kg	Approx.
Ambient temperature range (T_{amb})	-20 °C ... +45 °C	
Humidity	15 ... 95 %	Non condensing
Protection type according to EN 60529	IP54	
Maximum elevation above sea level	1'000 m	Option: 3'500 m
Cooling		Liquid cooled with external heat exchanger
Cooling fluid frost protection	-20°C	Water 60%, glycol 40 %

Standards of Converter

CE conformity / EMC		Yes / EN 61000-6-2, EN 61000-6-4
---------------------	--	----------------------------------

Container Layout / Variants of Foundations

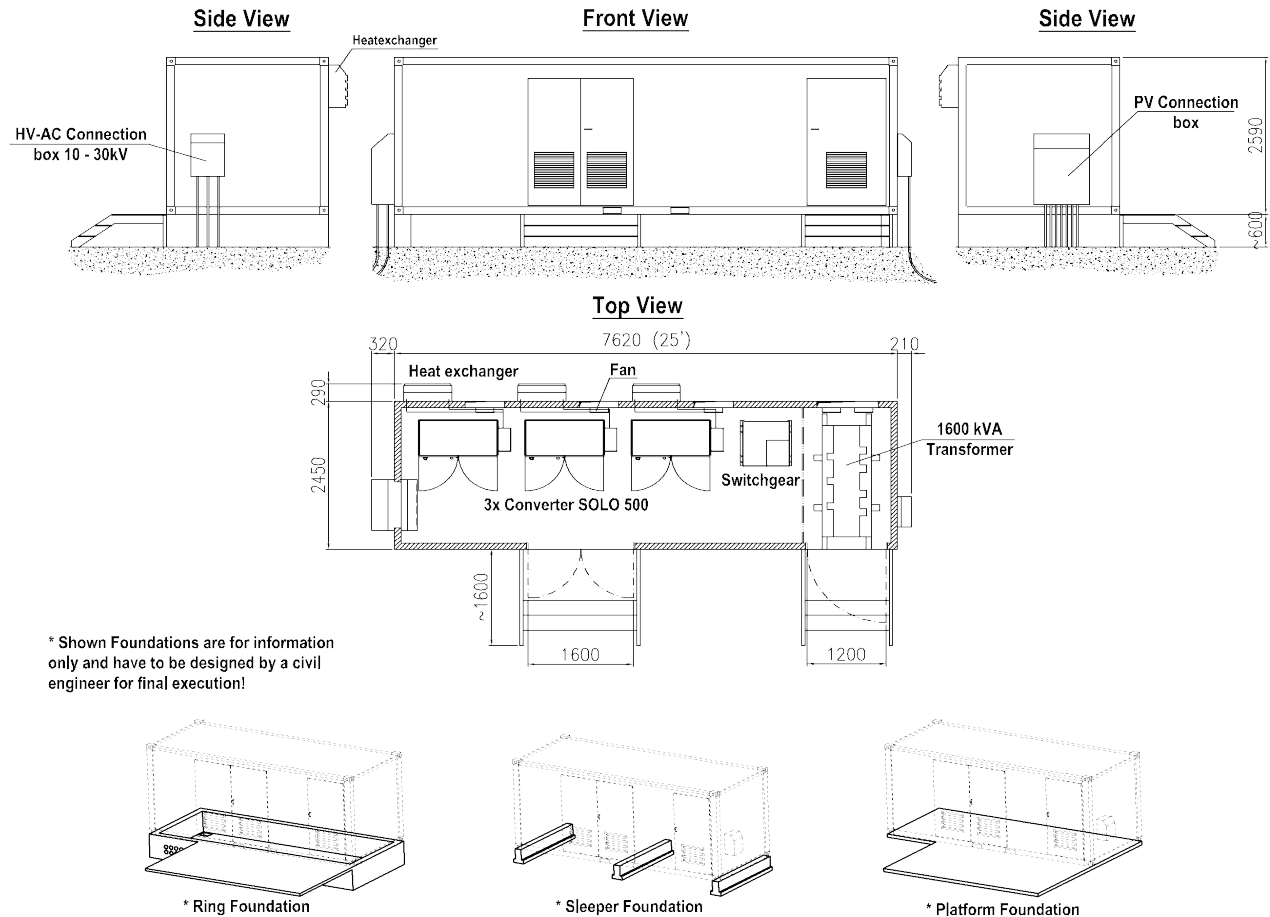

Subject to change, May 2011

Ordering Information

For technical or commercial information please contact the IDS sales office

IDS Trade AG
sales@ids.ch • www.ids.ch

Samstagernstrasse 55
Phone +41 44 562 06 00

CH - 8832 Wollerau / Switzerland
Fax +41 44 562 06 06