

SOLO Station 500-1

String PV Station 500 kW
with High Voltage Transformer

IDS Trade AG
Samstagernstrasse 55
CH - 8832 Wollerau / Switzerland

Phone +41 44 562 06 00
Fax +41 44 562 06 06
sales@ids.ch
www.ids.ch

Datasheet

Type	SOLO Station 500-1	ISS-5-20
------	--------------------	----------

Grid Data

Nominal AC power	P_{AC}	500 kW
Nominal AC current	I_{AC}	14.4 A
AC operating voltage	U_{AC}	20 kV; +10 % / -15 %
Grid frequency	f_{AC}	50 Hz / 60 Hz; ± 10 %
Surge arrester		Yes
Harmonic distortion	%THD (I_{AC})	< 3 % (at maximum AC power)
Power factor	$\cos \varphi$	0.95 capacitive ... 0.95 inductive
Efficiency (without transformer)		98.5 %
Euro eta (without transformer)		98 %
Auxiliary power supply		3 x 400 VAC; 50/60Hz; TN-S; surge protection type 2

Photovoltaic Data

Nominal PV power	P_{PV}	508 kW
Control strategy		Maximum Power Point Tracking (MPPT)
Number of PV input trackers		1
DC voltage range for MPPT		600 VDC ... 1200 VDC
Maximum permissible PV voltage	U_{PVmax}	1200 VDC
Voltage ripple (PV input)	U_{PP}	< 3 %
Surge protection		Type 2 (monitored)
Grounding		Floating (optional connection to PV input)

Communication and Control Interface

Communication interface	Ethernet (optional: GSM- or line modem)
-------------------------	---

Options

Power reduction control / BDEW regulations, further on request
Connecting PV(-) or PV(+) input to ground (inclusive earth current measurement)
Communication: GSM- or line modem
Energy counter

SOLO Station 500-1 Datasheet



Container and Ambient Conditions

Dimensions (without foundation)	L x W x H	6058 x 2230 x 2590 mm
Foundation height	H	600 mm (depending on environmental conditions)
Weight	m	7400 kg (approx.)
Ambient temperature range	T _{amb}	Standard: -20 °C ... +45 °C; Extended: -50 °C ... +60 °C
Humidity		15 ... 95 %
Protection type according to EN 60529		IP54 (further on request)
Maximum elevation above sea level		Standard: 1'000 m (above derating); Extended: 5'000 m
Cooling		Liquid cooled with external heat exchanger
Cooling fluid		Standard: Water +40 % glycol, frost protection down to -25 °C Extended: Water +50 % glycol, frost protection down to -50 °C

Standards of Converter

CE conformity / EMC		Yes / EN 61000-6-2, EN 61000-6-4
---------------------	--	----------------------------------

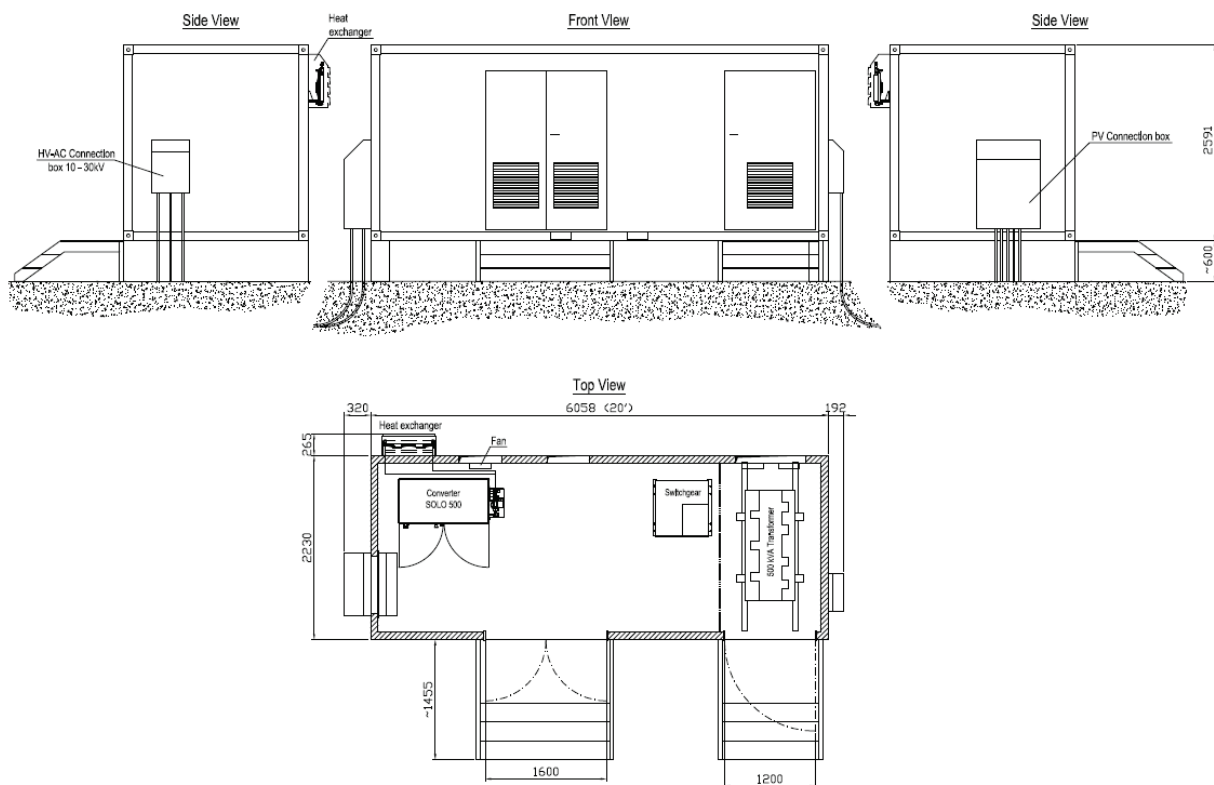

Subject to change, June 2010

Ordering Information

For technical or commercial information please contact the IDS sales office

IDS Trade AG
sales@ids.ch www.ids.ch

Samstagernstrasse 55
Phone +41 44 562 06 00

CH - 8832 Wollerau / Switzerland
Fax +41 44 562 06 06